

osborn Deburring wheel brushes

Suitable for deburring, glazing, roughening, descaling, removing mold, enamels, etc.
High density brushes with short "T" trim length for more aggressive action and maximum cut

With twist knots of tempered steel wire Ø 0,50 mm

For heavy-duty applications with high rotational speed - Long lasting and highly resistant to breaking

| Diameter D | mm | 200 | 250 |
|----------------------|--------|-------------|-------------|
| Code | | D 4055 0200 | D 4055 0250 |
| D 4055 | Each € | | |
| A face width approx. | mm | 13 | 15 |
| Wire free length T | mm | 42 | 42 |
| B hole | mm | 20 | 25,4 |
| Knots of wire | n° | 34 | 48 |
| Max speed | rpm | 8500 | 4500 |

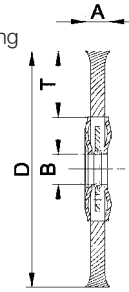

With nylon filaments coated with silicon carbide grit - Heavy-duty

For deburring and smoothing surfaces in metal, wood and synthetic materials - Suitable for both dry and wet machining - Highly flexible, they can fit any workpiece without clogging the work area
Resistant to low-concentration acids and alkaline solutions

To increase the work area, several brushes can be combined on the same shaft

A face width approx. 18 mm - Max speed 6000 rpm - 2 pcs.

| Diameter D | mm | 150 | 200 |
|---------------------|--------|-------------|-------------|
| Code | | D 4057 1150 | D 4057 1200 |
| D 4057/1 - Grit 80 | Each € | | |
| Code | | D 4057 2150 | D 4057 2200 |
| D 4057/2 - Grit 120 | Each € | | |
| Code | | D 4057 3150 | D 4057 3200 |
| D 4057/3 - Grit 180 | Each € | | |
| Wire free length T | mm | 32 | 35 |
| B hole | mm | 13 | 19 |

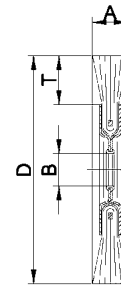

Small brushes for mould makers, goldsmith's, dentists'

In crimped metal wire - Ø 0,10 mm - Shank Ø 2,35 mm

End brush - Ø 6 mm - Max speed 20000 rpm

| | | | | |
|------------------|----------|--------------------|--------|----|
| Code D 4062 1000 | D 4062/1 | Steel | Each € | 20 |
| Code D 4062 2000 | D 4062/2 | Brass | Each € | 20 |
| Code D 4062 3000 | D 4062/3 | In stainless steel | Each € | 20 |

Cup brush - Ø 10 mm - Max speed 20000 rpm

| | | | | |
|------------------|----------|--------------------|--------|----|
| Code D 4063 1000 | D 4063/1 | Steel | Each € | 20 |
| Code D 4063 2000 | D 4063/2 | Brass | Each € | 20 |
| Code D 4063 3000 | D 4063/3 | In stainless steel | Each € | 20 |

Wheel brush - Ø 18 mm - Max speed 20000 rpm

| | | | | |
|------------------|----------|--------------------|--------|----|
| Code D 4064 1000 | D 4064/1 | Steel | Each € | 20 |
| Code D 4064 2000 | D 4064/2 | Brass | Each € | 20 |
| Code D 4064 3000 | D 4064/3 | In stainless steel | Each € | 20 |



In white cotton yarn - Circular end shape - Ø 22 mm - Max speed 18000 rpm

| | | | |
|------------------|--------|--------|----|
| Code D 4066 0000 | D 4066 | Each € | 20 |
|------------------|--------|--------|----|

Drive arbor

Nickel-plated finish - With nut and washer - Shank Ø 6x30 mm - For brushes up to Ø 100 mm

| For brushes with hole Ø | mm | 10 | 13 |
|-------------------------|--------|-------------|-------------|
| Code | | D 4068 9010 | D 4068 9013 |
| D 4068/9 | Each € | | |
| Overall length | mm | 65 | 70 |



ABC TOOLS Buffs

For cleaning and polishing metals and plastics - In cotton fabric, airway buffs

For use with grinders and polishing machines - A polishing speed above 30 m/sec is recommended

Thickness 12 mm - Hole diameter 20 mm - Max speed 6000 rpm

| Diameter | mm | 150 | 200 |
|----------|--------|-------------|-------------|
| Code | | D 4069 0150 | D 4069 0200 |
| D 4069 | Each € | | |

